

Arthur Court, Queensway, London, W2
£550 Weekly | 2 Bedrooms

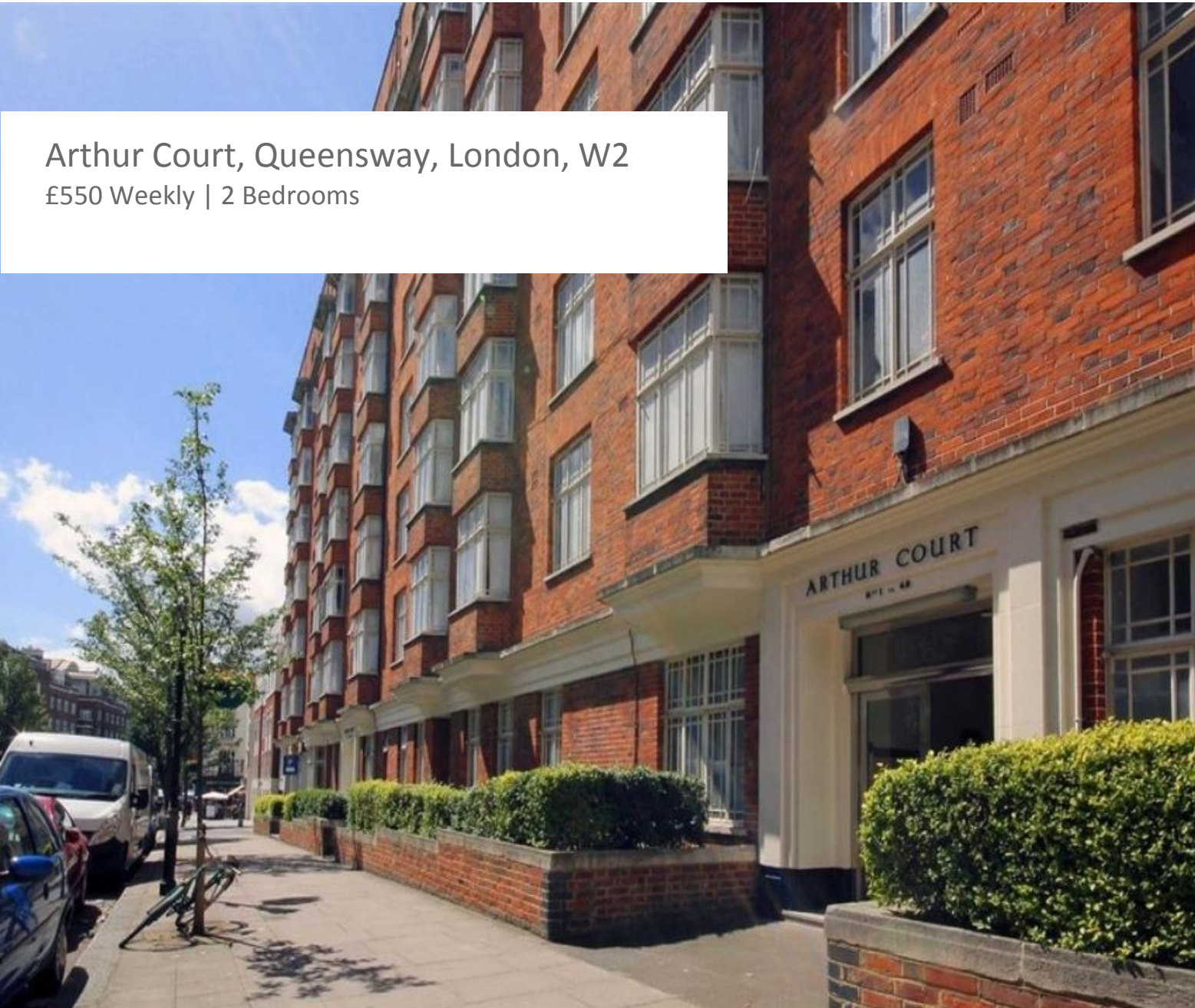

Arthur Court, Queensway, London, W2

A spacious two double bedroom apartment on the first floor of a portered block on Queensway. With lift access and wooden floors, this modern and charming property has a large separate kitchen and period features.

Arthur Court is moments from the local shops, bars and restaurants along Queensway. Local transport is nearby and Hyde Park is only a short walk away.

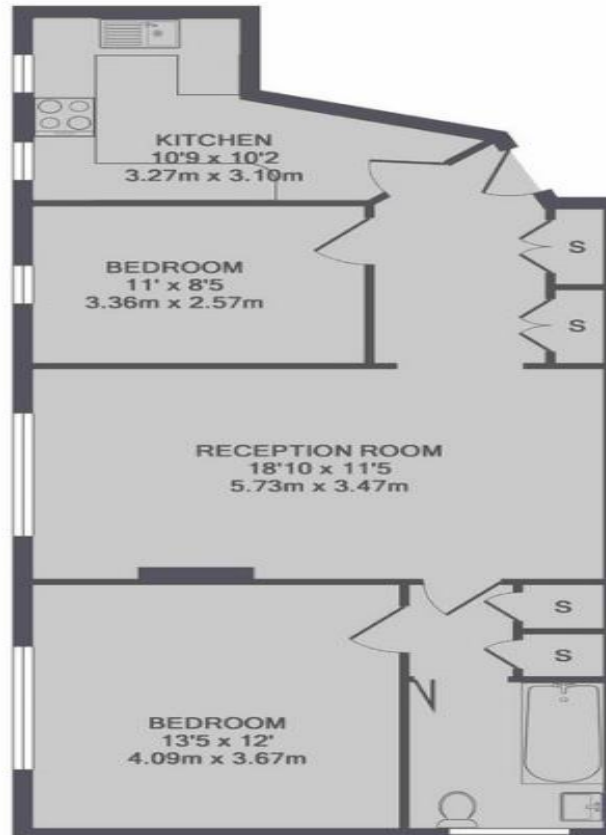

TOTAL APPROX. FLOOR AREA 744 SQ.FT. (69.1 SQ.M.)

Please note tenant fees may apply

Misrepresentation Act 1967. These particulars and the descriptions and measurements herein do not constitute representation and whilst every effort has been made to ensure accuracy this cannot be guaranteed.

Energy Efficiency Rating		Environmental(CO2) Impact Rating	
Current	Potential	Current	Potential
(91-100) A	(81-90) B	(10-100) A	(10-100) B
(81-90) B	(71-80) C	(10-100) C	(10-100) D
(71-80) C	(61-70) D	(10-100) D	(10-100) E
(61-70) D	(51-60) E	(10-100) E	(10-100) F
(51-60) E	(41-50) F	(10-100) F	(10-100) G
(41-50) F	(31-40) G	(10-100) G	
(31-40) G			

Current Energy Rating: **B1** (61-70)
Potential Energy Rating: **B1** (81-90)
Current Environmental Rating: **D** (59)
Potential Environmental Rating: **B** (84)

England & Wales | Directive 2002/91/EC